

ALIVIO Front Chainwheel

FC-M411-S Silver Version
FC-M411-L Black Version

FC-M411-NS Neutral Silver Version

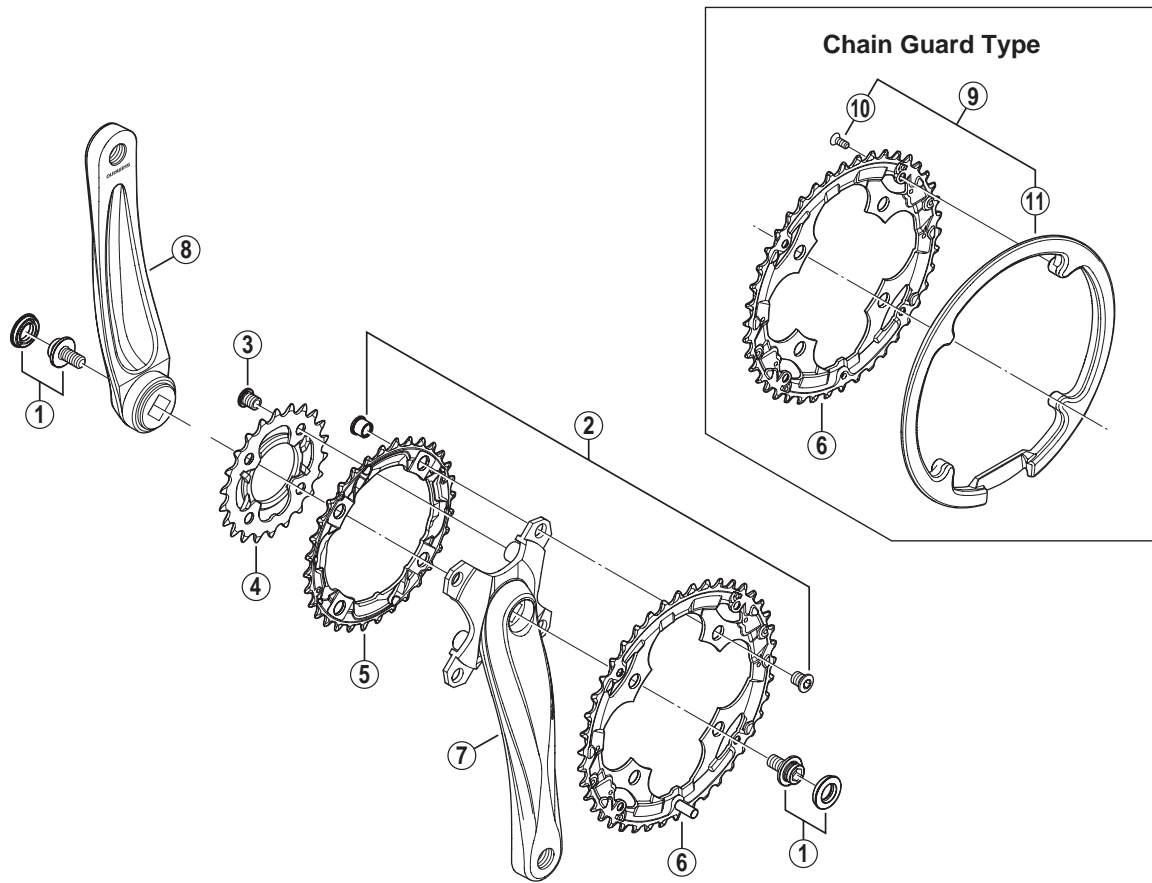

• Bolt circle diameter: 104 mm...(For outer gear and middle gear), 64 mm...(For inner gear)

FC-M410

ITEM NO.	SHIMANO CODE NO.	DESCRIPTION	INTERCHANGEABILITY
1	Y1FP98010	Crank Arm Fixing Bolt & Cap	A
2	Y1FM98020	Double Gear Fixing Bolt (M8 x 8.5) & Nut (4 sets)	A
3	Y1FM98030	Inner Gear Fixing Bolt (M8 x 8.5 / 4 pcs.)	A
4	Y1GM98010	Chainring 22T (Silver) & Chain Protector	
5	Y1GM98020	Chainring 32T (Silver)	
* 6	Y1KN98050	Chainring 42T (Black)	
* 6	Y1GU98020	Chainring 42T (Black) for Chain Guard	
	Y1GL98010	Right Hand Crank Arm 170 mm (Silver) for FC-M411-S	
	Y1GL98020	Right Hand Crank Arm 170 mm (Black) for FC-M411-L	
* 7	Y1GL98140	Right Hand Crank Arm 170 mm (Neutral Silver) for FC-M411-NS	
	Y1GL98030	Right Hand Crank Arm 175 mm (Silver) for FC-M411-S	
	Y1GL98040	Right Hand Crank Arm 175 mm (Black) for FC-M411-L	
* 7	Y1GL98150	Right Hand Crank Arm 175 mm (Neutral Silver) for FC-M411-NS	
	Y1GK98050	Left Hand Crank Arm 170 mm (Silver) for FC-M411-S	A
	Y1GK98060	Left Hand Crank Arm 170 mm (Black) for FC-M411-L	A
* 8	Y1GL98160	Left Hand Crank Arm 170 mm (Neutral Silver) for FC-M411-NS	
	Y1GK98070	Left Hand Crank Arm 175 mm (Silver) for FC-M411-S	A
	Y1GK98080	Left Hand Crank Arm 175 mm (Black) for FC-M411-L	A
* 8	Y1GL98170	Left Hand Crank Arm 175 mm (Neutral Silver) for FC-M411-NS	
9	Y1GM98090	Chain Guard & Fixing Screws	A
10	Y1D298010	Chain Guard Fixing Screw (4 pcs.)	A
11	Y1GM13000	Chain Guard	A

A: Same parts.

B: Parts are usable, but differ in materials, appearance, finish, size, etc.

Absence of mark indicates non-interchangeability.

Jul-2010-2466C
 © Shimano Inc. I

Specifications are subject to change without notice.

SHIMANO