

RAPIDFIRE LEVERS: Installation



1. INBOARD OR OUTBOARD INSTALLATION

Use a handlebar grip with a maximum outer diameter of 32 mm. This shifting lever can be installed on either the inboard or the outboard side of the brake lever.



INBOARD INSTALL



OUTBOARD INSTALL



Shifting lever position can be adjusted by sliding to the right or left. Install the shift lever in a position where it will not obstruct brake and gear shift operation.

Do not use a combination which causes obstruction of the brake.



In the case of carbon handlebars, it may be necessary to lower the tightening torque in order to prevent damage to the handlebar.

Consult the bicycle or handlebar manufacturer regarding the appropriate torque for carbon handlebars.



2. CONNECTING AND SECURING INNER CABLE

Operate the lever (B) two times or more to set the lever to the lowest position. Then remove the inner hole cover and connect the inner cable.



Tightening Torque:
0.3 - 0.5 Nm {3 - 4 in. lbs.}

Install the inner hole cover by turning it as show in the photo until it stops. Do not turn it any further than this, otherwise it may damage the thread on the cover.

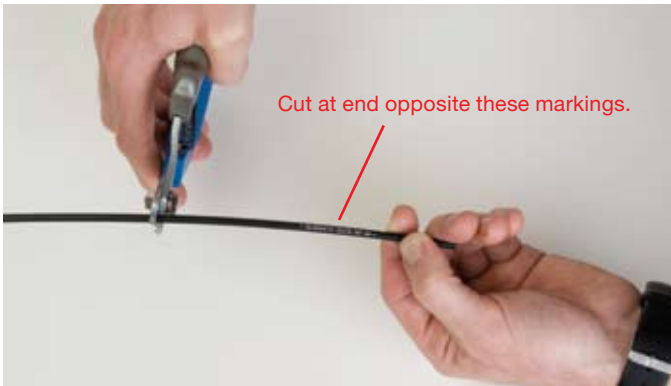

3. CUTTING THE OUTER CASING

Cut the outer casing at the end opposite to the one with the markings.

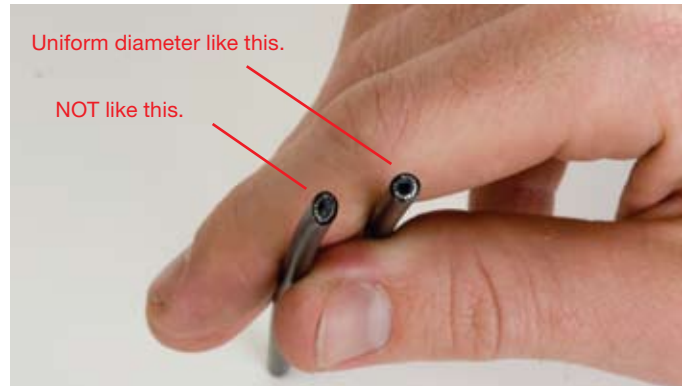

Make sure the end cut is round and even so that the inside of the hole has a uniform diameter.



Attach the same outer end cap to the cut end of the outer casing.



Shifting performance on page #.